

**P/N 502042**  
**BODY MOUNT MIRROR**

ALL PASSENGER CAR

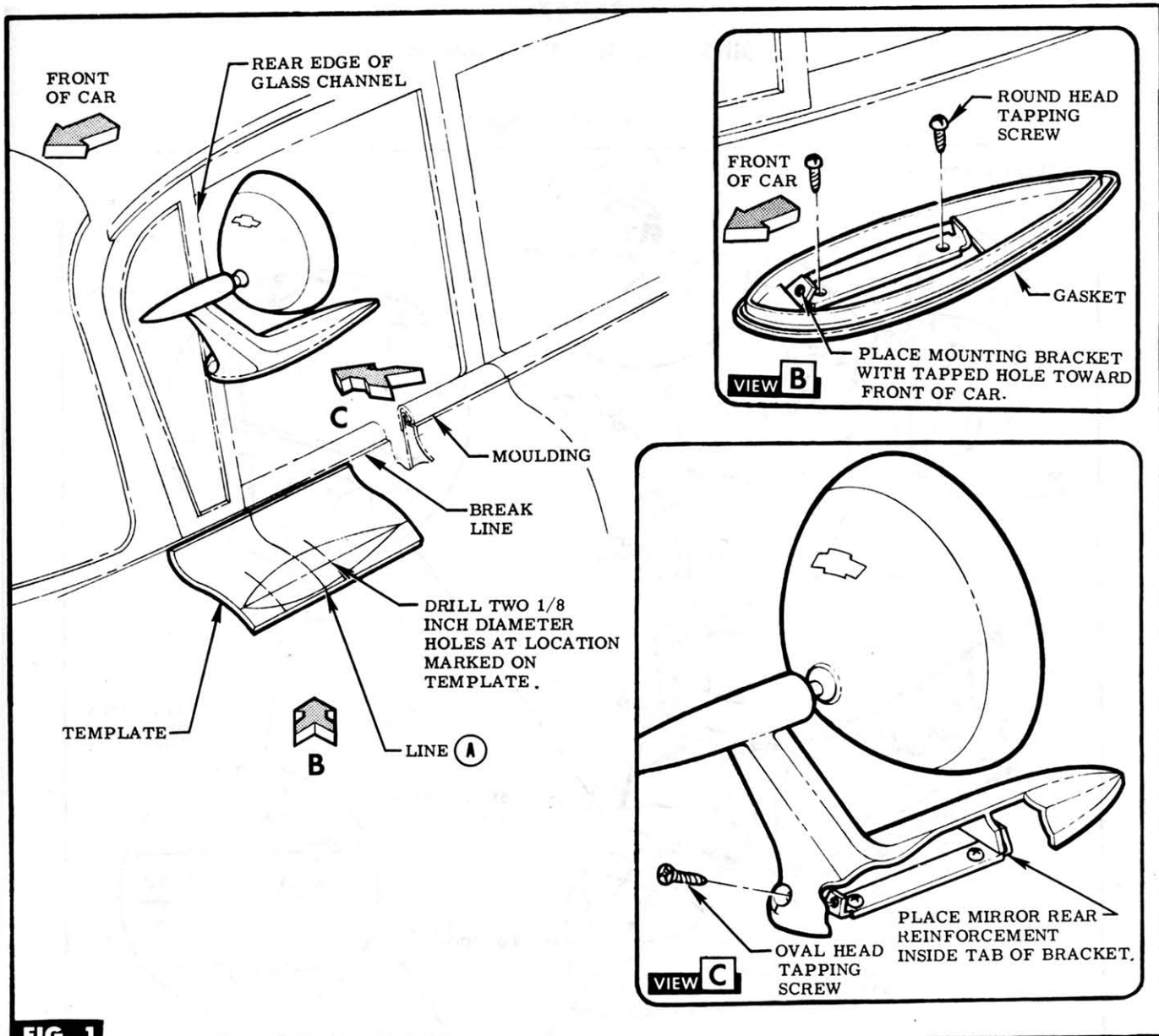

**FIG. 1**

**ALL PASSENGER CARS (EXCEPT SEDAN DELIVERY)**

**STEP 1** LINE UP THE TOP OF THE TEMPLATE WITH THE BREAK LINE ON THE DOOR JUST BELOW THE MOULDING AS SHOWN IN FIGURE 1. ALIGN LINE A WITH THE REAR EDGE OF THE GLASS CHANNEL AS SHOWN.

**STEP 2** DRILL TWO 1/8 INCH DIAMETER HOLES AT THE LOCATION MARKED ON THE TEMPLATE, REMOVE THE TEMPLATE.

**STEP 3** PLACE THE MOUNTING BRACKET ON THE CAR WITH THE TAPPED HOLE TOWARD THE FRONT OF THE CAR AS SHOWN IN VIEW B. ATTACH THE MOUNTING BRACKET WITH THE TWO ROUND HEAD TAPPING SCREWS FURNISHED.

**STEP 4** PLACE THE GASKET OVER THE MOUNTING BRACKET.

**STEP 5** PLACE THE MIRROR ON THE GASKET, SECURING THE REAR REINFORCEMENT (INSIDE THE MIRROR BASE) AGAINST THE INSIDE OF THE REAR TAB OF THE MOUNTING BRACKET AS SHOWN IN VIEW C. INSTALL THE CHROME OVAL HEAD TAPPING SCREW INTO MOUNTING BRACKET AND TIGHTEN.

**FOR SEDAN DELIVERY**

**STEP 1** LOCATE THE TWO EXISTING 1/8 INCH DIAMETER HOLES IN THE DOOR. CONTINUE THE INSTALLATION DESCRIBED IN THE PRECEDING STEPS 3, 4 AND 5.

